

# TAP3303 – Luxury monobloc tap

Key:	Description:	APX size (mm):	Base material	Colour:	QTY:
A1	Spout	305 x 110	ABS	Chrome	1
A2	O-ring	2.5 x 23.5 OD	Rubber	Black	1
A3	O-ring	2.5 x 17.5 OD	Rubber	Black	1
A4	Spout grub screw	M4	Steel	Steel	1
B1	Body	65 x 100 x 55	Brass & ABS	Chrome	1
C1	Hot indicie	19.5 x 6.5	Plastic	Black	1
C2	Handle screw	M5 x 17.5	Brass	Brass	1
C3	Handle	48 x 45	ABS	Chrome	1
C4	Hot valve	½" CD, length 55mm	Brass	Brass / chrome	1
D1	Cold indicie	19.5 x 6.5	Plastic	Black	1
D2	Handle screw	M5 x 17.5	Brass	Brass	1
D3	Handle	48 x 45	ABS	Chrome	1
D4	Cold valve	½" CD, length 55mm	Brass	Brass / chrome	1
E1	Upper seal	2.5 x 40 OD	Rubber	Black	1
E2	Fixing stud	M8 x 90	Steel	Silver	1
E3	Lower gasket	47 x 1.8	Rubber	Black	1
E4	Metal horseshoe	50 x 3	Steel	Silver	1
E5	Fixing nut	12 AF x 30	Brass	Brass	1
F1	Cold tail pipe	255 x 15 x M12	Copper	Copper	1
F2	Hot tail pipe	255 x 15 x M12	Copper	Copper	1
X1	Fixing kit assembly	N/A	N/A	N/A	1
X2	Complete spout assembly	N/A	N/A	N/A	1

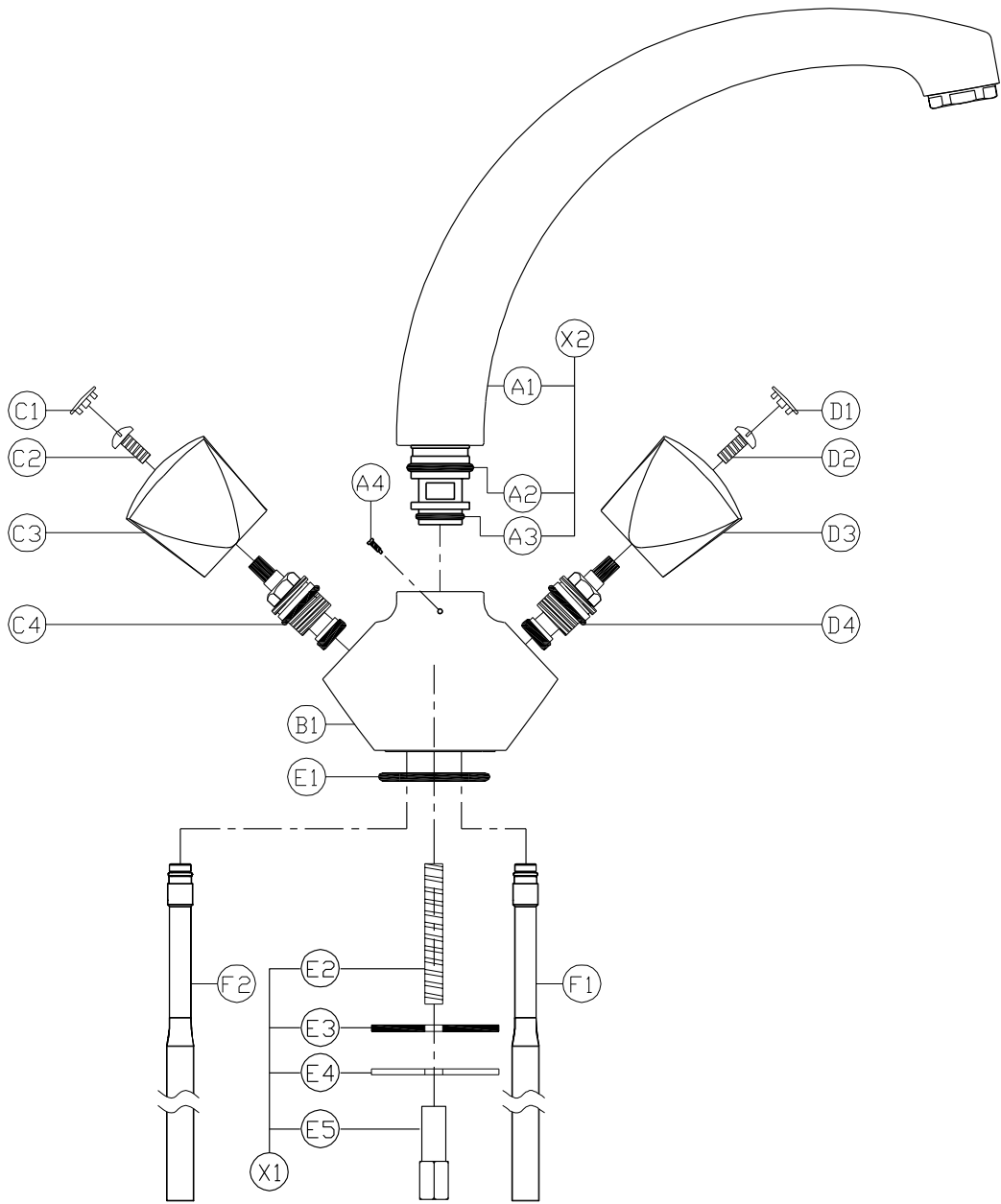

# TAP3303 - Luxury monobloc service drawing v1

(c) abode home products ltd  
www.abode.eu

our policy is to continually  
improve and develop products,  
and accordingly we reserve the  
right to amend specifications  
without prior notice

**General Advice:**

- These instructions are intended as a guide only, if you are in any doubt you should seek the advice of a qualified professional.
- Take care not to mark finished parts with screwdrivers or other tools.
- Use a pair of rubber gloves to get a better grip on decorative hand tight parts.
- Ensure all parts are reassembled tightly.
- After maintenance test that all assemblies are water tight and function correctly.
- Always isolate the hot and cold water supplies before starting any maintenance, once isolated you should drain any residual water from your system.

**To replace the hot valve:**

1. Lever out the dust cap (C1) using a small precision screwdriver or fingernail.
2. Unscrew the crosshead screw (C2)
3. Pull the handle (C3) away from the tap body.
4. Holding the tap body (B1) unscrew the valve (C4) using a 17mm ring spanner or adjustable wrench.
5. Clean any debris from the chamber in the tap body (B1).
6. Reassemble the tap in the reverse order.

**To replace the spout o-rings:**

1. Whilst holding body (B1) unscrew the spout grub screw (A4)
2. Pull the spout (A1) vertically away from the body (B1).
3. Remove the old o-rings (A2 & A3) using a small screwdriver or similar.
4. Ensure the inside of the body (B1) and the spout base is clean of dirt and grit with a soft wet cloth.
5. Carefully locate the new O-rings (A2 & A3) onto the spout base.
6. Grease the O-rings (A2 & A3) thoroughly with silicone or alternative similar grease.
7. Reassemble the tap in the reverse order.